



WALLTITE®

The airtight insulation solution

CI/SfB | | (45) | Yn6 | (M2)
October 2011

Concrete slab ground floor insulation

Data sheet 4.3

 **BASF**

The Chemical Company

Concrete slab ground floor insulation

Data sheet 4.3

Description

WALLTITE is applied directly to the concrete. Under-floor heating pipes can be fixed to the foam with the normal clips. A layer of tamped or self-levelling screed is applied, usually to a depth of 75mm. The process is extremely quick to apply compared to other methods and the problems of insulation boards lifting are avoided. Site overhead time and material waste from off-cuts are minimised.

Certification

BBA Certificate No. 11/4816.

WALLTITE has undergone various performance tests. Certificates are available on request.

Technical data

Specification:	Spray applied polyurethane foam directly onto concrete
Average depth:	60mm
Calculation Method:	EN ISO 13370
Perimeter:	40m
Area:	100.0m ²
P/A:	0.40m
Floor type:	Solid floor
Edge insulation:	None
U-value:	0.20W/m ² K

U-value calculation

Construction details (concrete ground floor)	Thickness (mm)
Inside surface	0.04
Screed, cast (BS 5250)	75
WALLTITE	60
Concrete, dense (BS 5250)	150
Ground	
U-value	0.20 W/m²K

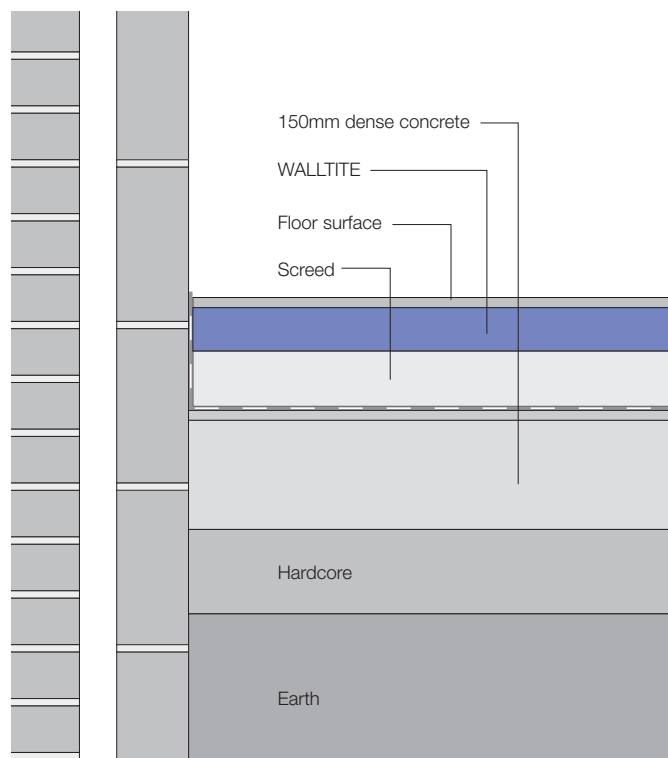

NS Plus

